

Steam Fresh Combi

User Guide



HS86-SFC-ZA

Contents	1
Machine Overview	2
General Safety Information	3
Operation	4 5 6 7 8 9
Maintenance	10 11
FAQs	12
Other Information	13

MACHINE OVERVIEW

2

Unit

- 1 Handle
- 2 Detergent trigger(hidden)
- 3 Handheld release button
- 4 Handheld steam trigger
- 5 Detergent control dial
- 6 Steam ready indicator
- 7 Steam control dial
- 8 ON/OFF switch
- 9 Water tank
- 10 Hard water filter(hidden)
- 11 Compact scrub brush
- 12 Floorhead
- 13 Concentration nozzle storage
- 14 Handle release button
- 15 Detergent tank
- 16 Quick cord release hook
- 17 Tool storage
- 18 Quick cord release hook
- 19 Floorhead release button
- 20 Carpet glider
- 21 Hose
- 22 Window tool
- 23 Window tool cloth
- 24 Large plastic brush
- 25 Small plastic brush
- 26 Metal brush
- 27 Scraper nozzle
- 28 Grout brush
- 29 Concentration nozzle
- 30 Detail nozzle
- 31 250 ml detergent
- 32 Accessory bag
- 33 Velcro microfibre cleaning pads

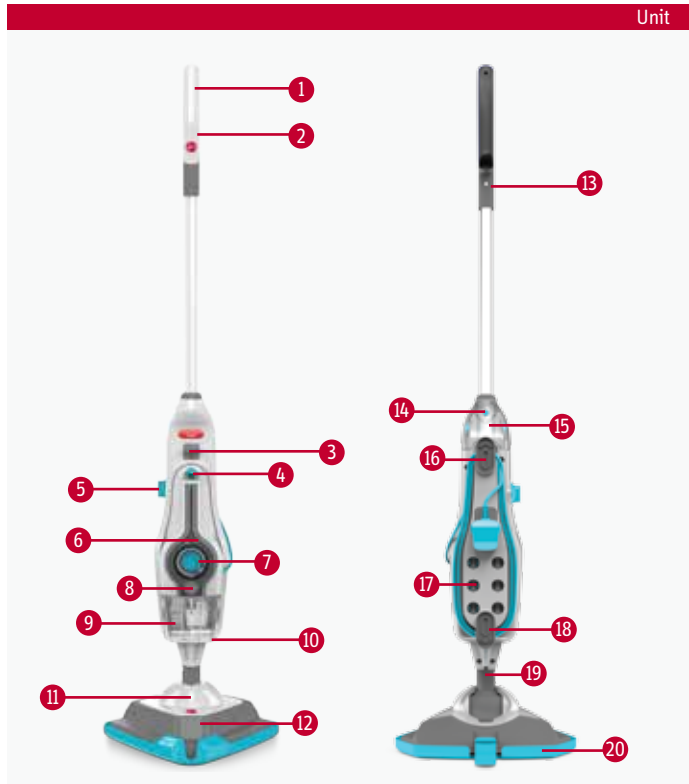

Accessories

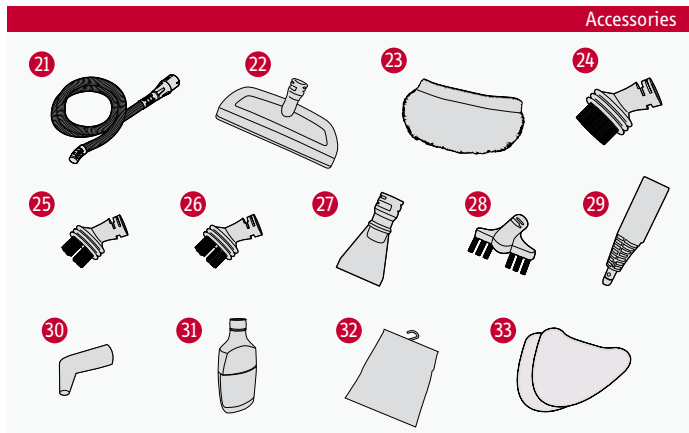

*NOTE: Some parts may vary according to model. Please check inside flap of box for more details.

3

GENERAL SAFETY INFORMATION

FOR HOUSEHOLD USE ONLY.



WARNING: Danger of scalding

When using the vacuum cleaner, basic safety precautions should always be observed, including the following:

1. Only use the steam mop indoors and keep the area you're cleaning well lit
2. Keep fingers, hair and loose clothing from moving parts and openings whilst using the steam mop
3. This appliance can be used by persons with reduced physical, sensory or mental capabilities or lack of experience and knowledge if they have been given supervision or instruction concerning use of the appliance in a safe way and understand the hazards involved. Children shall not play with the appliance
4. Please refer to floor manufacture's care recommendations before use, and test your flooring/carpet/rugs by running the steam mop over a small hidden area, if no pile distortion or no damage occurs continue cleaning. Not suitable for use on wax polished floors or furniture, acrylic surfaces and synthetic, velvet or steam/water sensitive materials
5. This steam mop should not be used to clean electrical appliances such as microwaves, oven, televisions and electrical heating systems, etc.
6. Only Hoover recommend cloths and solution should be used with this steam mop. Using other solutions will invalidate the guarantee
7. Don't touch any hot areas/accessories on your steam mop. It's normal for the steam mop and accessories to heat up during use, always allow them to cool down before handling
8. Don't use the steam mop if it has been dropped, if there are visible signs of damage or if it is leaking, if it has been immersed in water or left outdoors
9. Don't handle the plug or use the steam mop with wet hands
10. Don't pull or carry this steam mop by the power cord
11. Don't use the power cord as a handle, pull the power cord around corners or sharp edges or close a door over the power cord
12. Don't attempt to remove blockages with sharp objects as this may cause damage to the steam mop, remove blockages only as instructed in this guide
13. Don't aim the steam mop at people, animals, plants and electrical components such as interior of ovens or wires. Never touch the steam burst or floor head from a short distance (there is a risk of scalding)
14. Don't use the steam mop with incorrect voltage as this may result in damage or injury to the user. The correct voltage is listed on the ratings label
15. Don't leave this steam mop unattended while it is connected to the supply mains
16. Always make sure the concentration nozzle and accessories are securely connected to the handheld before use
17. Always fill the clean water tank with water only, never add perfume, stain remover or products containing alcohol. Filling the clean water tank with hot or boiling water will damage the machine and invalidate your guarantee
18. Always make sure tanks are fitted correctly before using the steam mop
19. Always vacuum your carpets thoroughly and ensure hard floor areas are free from grit and debris before using the steam mop
20. Always carry the steam mop by the handle
21. Always unplug the steam mop before carrying out any maintenance or when unattended
22. Turn off all controls on the steam mop before disconnecting or connecting the power cord, after use always wrap the power cord around the cord clips provided
23. Take extra care when cleaning on stairs
24. Always replace the fuse in the plug with a 13amp fuse.
25. Always protect the power cable from heated surfaces or near open flames
26. Use only CE approved 13amp extension cords, non-approved extension cords may overheat
27. Care should be taken to arrange the extension cord as it could be a trip hazard
28. Store the steam mop in a cool, dry area away from children
29. Before storing the steam mop please ensure all water/detergents tanks and hard water filter are thoroughly clean and dry
30. Keep the appliance out of reach of children when it is energised or cooling down

PLEASE KEEP INSTRUCTIONS FOR FURTHER USE.

Please read General Safety Information at the beginning before use.

Assembling your steam mop

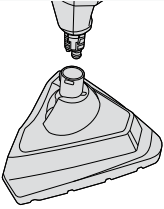

Push the main body down into the floor head until it clicks into place

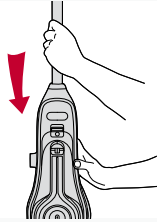

Push the handle into main body until it clicks into place



To stand steam mop upright push handle until clicks into place

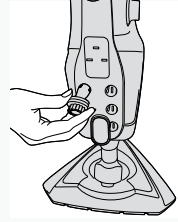

Insert tools into the back of the steam mop

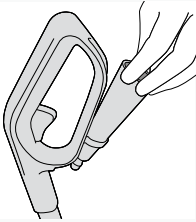

Insert concentration nozzle into the storage hook on the back of handle

5 OPERATION

IMPORTANT: If you don't want to use detergent on your flooring, turn detergent dial to OFF position. Always test on an inconspicuous area of flooring first before using detergent.

Filling twin tank

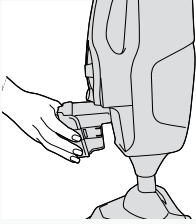

Press the water tank release buttons and pull the water tank to remove

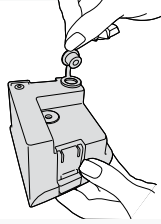

Pull the tab on the water tank cap to open

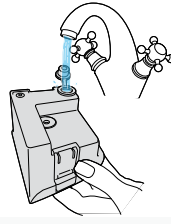

Fill the water tank with 300ml of water, replace the cap and push firmly to close

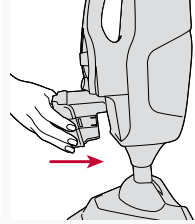

Slide the water tank back into the machine until it clicks into place

Filling detergent tank

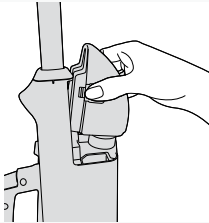

To remove the detergent tank press both release buttons and pull to release.

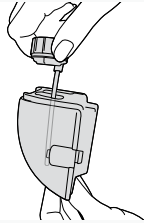

Twist the detergent tank cap anti-clockwise and lift to remove.

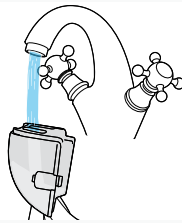

Pour 50ml of Hoover detergent and 150ml of water into the detergent tank.

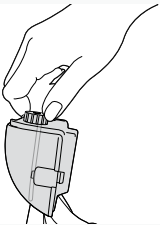

Replace the detergent tank cap and twist clockwise to close.

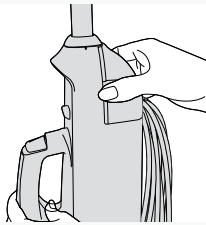

Insert the detergent tank back into the machine until it clicks into place.

- The steam mop and accessories get very hot during use, always allow them to cool down before handling.
- Always unplug and switch off the steam mop when assembling.
- Always switch off the steam mop before emptying the water tank or changing the cleaning pads/accessories.
- **IMPORTANT:** Please refer to floor manufacturer's care recommendations before use and test the steam mop on a discrete area of flooring to begin with.
- When using the steam mop, basic safety precautions should always be observed.
- Don't aim the steam mop at people, animals, plants and electrical components such as interior of ovens or wires. Never touch the steam burst or floor head from a short distance. (There is a risk of scalding)
- The steam mop is equipped with a thermostat and a thermal cut-out. If for any reason the steam mop overheats it will switch off. If this happens turn off and unplug the steam mop, allow to cool for a least 2 to 4 hours and re-start.

Using the steam mop

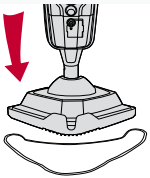

Place the microfibre pad on the floor white side facing up. Place steam mop onto pad making sure the entire pad covers the floor head

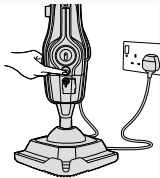

Plug into mains and press the power button to switch on. The blue light will illuminate to show power on. The green light will illuminate to show the steam mop is ready to use



Adjust the steam dial to desired setting

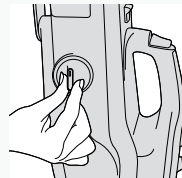

To steam your floors with detergent turn the dial to ON and without detergent turn the dial to OFF

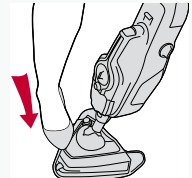

To recline the steam mop place foot on floor head and pull handle backwards

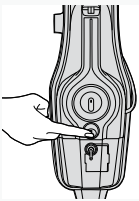

Push On/Off switch to turn machine on

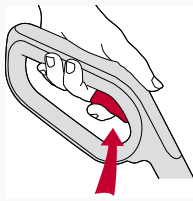

To produce steam squeeze the trigger in short bursts. Don't hold the trigger continuously to prevent over wetting floors

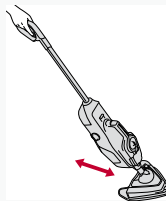

Move the steam mop slowly backwards and forwards across the floor paying particular attention to high traffic areas. Squeeze/release trigger as required

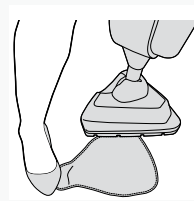

Hold corner of pad down with foot and lift steam mop to peel away

7 OPERATION

Refreshing carpets

IMPORTANT: When using on carpets, always make sure the velcro microfibre cleaning pad is used and covers the floor head entirely before using the carpet glider. Only use the carpet glider when refreshing carpets and turn the detergent dial to OFF.

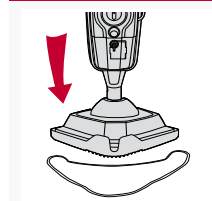

Place the microfibre pad on the floor white side facing up. Place steam mop onto pad making sure the entire pad covers the floor head

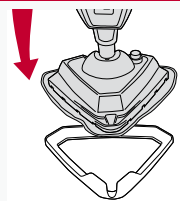

With microfibre pad attached, hook the steam mop into the front of the carpet glider and push to clip into place. Carpet glider should only be used when refreshing carpets

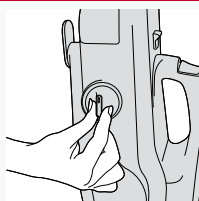

Turn the detergent dial to OFF when refreshing carpets

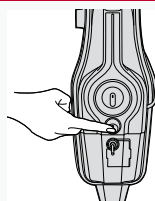

Push On/Off button to switch on



To recline the steam mop place foot on floor head and pull handle backwards

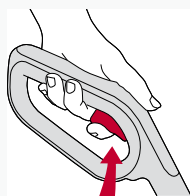

To produce steam squeeze the trigger. To prevent overly wetting the carpet, avoid holding the trigger continuously

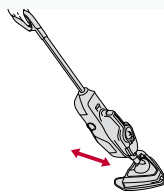

Move the steam mop slowly backwards and forwards across the carpet paying particular attention to high traffic areas

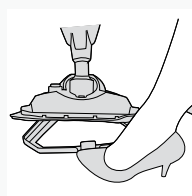

To release the carpet glider, place foot on clip and push down. Lift steam mop to unhook and remove

Using accessories

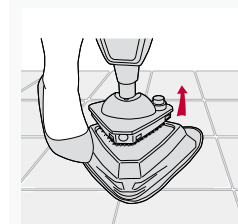

Place foot on outer floor head and gently pull away steam mop to release the compact scrub brush

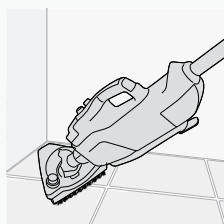

Move steam mop back and forwards across the floor, getting into corners and awkward places

IMPORTANT: Always switch off the steam mop before attaching or removing the floor head.

Using the handheld steamer

WARNING: Always switch off the handheld steamer before attaching the concentration nozzle and accessories.

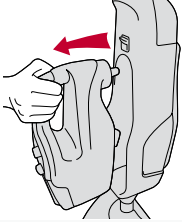

Lift the handheld release button and gently pull the handheld to release from the steam mop



Remove water tank and refill before use



When using the handheld always attach the concentration nozzle or accessory connector hose. Push the concentration nozzle/accessory connector hose onto the handheld nozzle and twist clockwise to lock into position

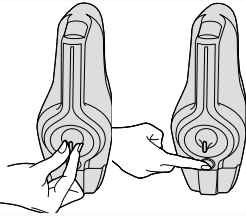

Adjust the dial on the front of the handheld to desired steam setting and push On/Off button to switch on

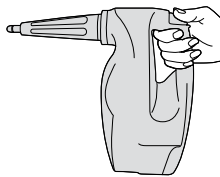

Insert the detergent tank back into the machine until it clicks into place

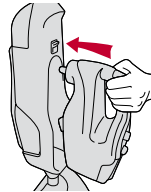

Insert the detergent tank back into the machine until it clicks into place

Using small accessories

Using large accessories

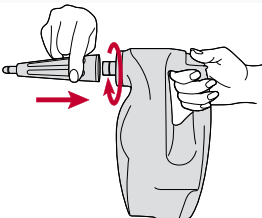

Small tools can be attached via concentration nozzle, twist clockwise until locked into position and secure. To remove concentration nozzle, turn anticlockwise

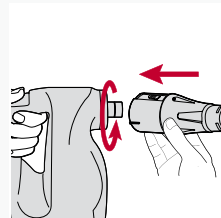
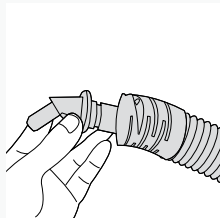

Larger accessories can be attached using the accessory connector hose. To attach the hose twist clockwise until locked into position and secure. To remove accessory connector hose, turn anti-clockwise

9

OPERATION

IMPORTANT: Taps should be turned off when steaming around them. Don't steam clean ovens, oven surfaces or grills when hot. Allow to cool to room temperature.

Using the tools

Concentration nozzle

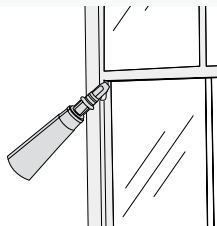

Use to remove soap scum in baths and shower enclosures and to clean heavily soiled areas in kitchens

Brushes

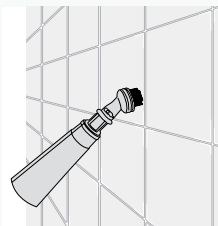

Ideal for any surface from tiles, sinks, toilets and oven tops

Squeegee tool



Great for leaving your windows, tiles and mirrors gleaming

Upholstery/cloth tool

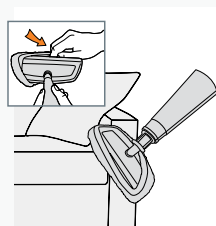

Attach the cloth to the squeegee tool for use on upholstery and clothes

Grout brush

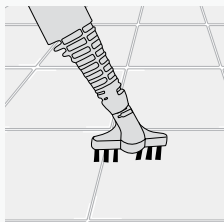

Lifts embedded dirt from in between tiles

Detail nozzle



For hard to reach areas e.g. around taps

Scraper tool

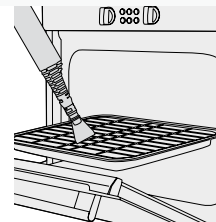

Ideal for removing dried on residue from ovens, work surfaces and pans

Emptying the twin tank

IMPORTANT: Allow the steam mop to fully cool down before performing any maintenance or troubleshooting checks. Don't leave water or detergent in the tanks between uses, as this can affect the machine's performance; the water/detergent tanks need to be emptied and rinsed after each use.

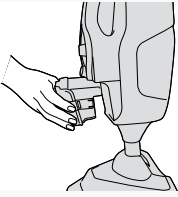

Press the water tank release button and lift the water tank by the handle

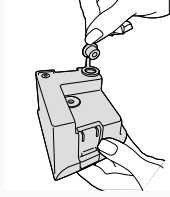

Pull the tab on the water tank to open

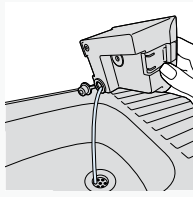

Empty any excess water over the sink

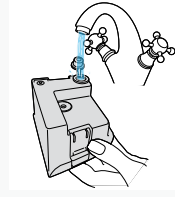

Rinse water tank with water and replace water tank tab, push firmly to close before replacing back onto the machine

Emptying the detergent tank

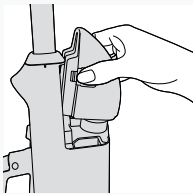

Push both detergent tank release buttons and lift to remove

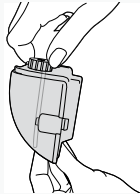

Twist detergent tank cap anti-clockwise and lift to remove

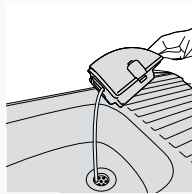

Empty any excess detergent over the sink

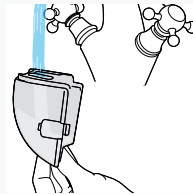

Rinse detergent tank with water and replace detergent tank cap, turn clockwise to tighten before replacing back onto the machine

Removing cleaning pads

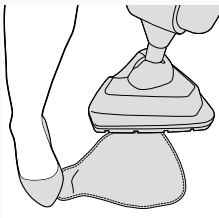

Hold corner of pad down with foot and lift steam mop to peel away

Max 40°C

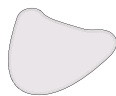

All cleaning pads are machine washable (Max 40°C) allow to fully dry before use

IMPORTANT: Don't operate the steam mop without hard water filter in place. The condition of the filter affects the performance of your machine, check and change filter periodically. If you live in an area of hard water the filter will discolour or darken over time. Depending on water hardness and frequency of use, the filter should be changed every 3 to 6 months or if the filter has discoloured.

Replacing the hard water filter

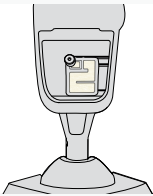

Remove the water tank to access the hard water filter

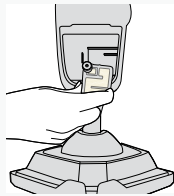

Pull to remove the hard water filter

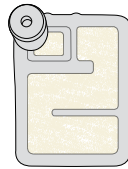

New filter (beige/cream colour)

3-6 Months

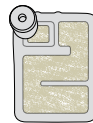

Hard water filter should be replaced every 3 to 6 months or if discoloured

Removing blockages

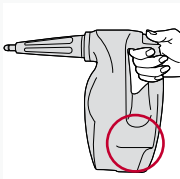

If there is an obstruction to the steam flow through the machine, steam may be released through the bleed valve located on the side of the handheld

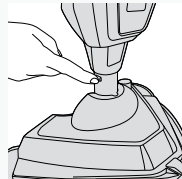

To remove the floor head from main body push the floor head release button and lift

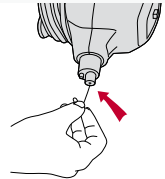

After floor head is removed, using a thin object such as a paper-clip (in the area shown), insert to remove the blockage

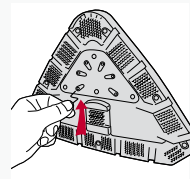

With the pad removed from the floor head, insert a small thin object such as a paper-clip into the steam holes to remove a blockage

Is there an accessory missing?

- Check the 'Machine Overview' panel to make sure the part is included with your machine.

Why does my steam mop have no power?

- Check the On/Off switch is in the On position
- The plug may not be fully pushed into the electrical socket
- Check the fuse in the plug if this needs replacing, always replace with a 13amp fuse

Why is the steam mop not producing steam/solution?

- There may be no water in twin tank, check the twin tank has water
- Check the twin tank is securely fitted and the hard water filter is in place
- Hard water filter may be blocked and need to be replaced
- Steam path may be blocked. Go to 'Maintenance' page
- Check correct setting has been selected, to use solution selected vinyl or tile
- Check the solution has been diluted to correct strength

Why won't the cleaning pad pick up dirt?

- The cleaning pad may already be saturated or dirty, wash the cleaning pad. Go to 'Maintenance' page

Why is steam coming from the side of the steam mop?

- Steam coming from the side of the machine may indicate a blockage within the machine. To clear any blockages go to 'Maintenance' page

Warning: Always unplug the steam mop before performing maintenance/troubleshooting checks

Please affix proof of purchase/receipt here
In the event of a claim under warranty this receipt must be produced.

WARRANTY

1. Home of Living Brands (Pty) Limited warrants to the original purchaser of this product ("the customer") that this product will be free of defects in quality and workmanship which under normal personal, family or household use and purpose may manifest within a period of 1 (one) year from the date of purchase ("warranty period").
2. Where the customer has purchased a product and it breaks, is defective or does not work properly for the intended purpose, the customer must notify the supplier from whom the customer bought the product ("the supplier") thereof within the warranty period. Any claim in terms of this warranty must be supported by a proof of purchase. If proof of purchase is not available, then repair, and/or service charges may be payable by the customer to the supplier.
3. The faulty product must be taken to the supplier's service centre to exercise the warranty.
4. The supplier will refund, repair, or exchange the product in terms of this warranty subject to legislative requirements. This warranty shall be valid only where the customer has not broken the product himself, or used the product for something that it is not supposed to be used for. The warranty does not include and will not be construed to cover products damaged as a result of disaster, misuse, tamper, abuse or any unauthorised modification or repair of the product.
5. This warrant will extend only to the product provided at the date of the purchase and not to any expendables attached or installed by the customer.
6. If the customer requests that the supplier repairs the product and the product breaks or fails to work properly within 3 (three) months of the repair and not as a result of misuse, tampering or modification by or on behalf of the customer, then the supplier may replace the product or pay a refund to the customer.
7. The customer may be responsible for certain costs where the products returned are not in the original packaging, or if the packaging is damaged. This will be deducted from any refund paid to the customer.

HOME OF LIVING BRANDS (PTY) LTD (JOHANNESBURG)

JOHANNESBURG

TEL NO. (001) 490-9600

CAPE TOWN

TEL NO. (021) 552-5161

DURBAN

TEL NO. (031) 792-6000

www.hoover.za

Service & Help

If you have queries or concerns about using your Hoover, please visit www.hoover.za

Technical Specification

Voltage: 220-240V ~50Hz

Wattage: 1600W

Cord length: 8m (approx)

Weight: 3.7 kg (approx)

Subject to technical change without notice.

Consumables

Hoover SA Microfibre Pads (Type 1)	1-1-134355-00
Hoover SA Steam Pads (Type 2)	1-1-134356-00
Hoover SA Coral Pads (Type 3)	1-1-134357-00
Hoover Steam Detergent 500ML	1-9-131842-00

EEC Statement of Compliance

Manufacturer/EEC importer: Hoover, hereby on our own responsibility, declare that the HS86-SFC-ZA series is manufactured in compliance with the following Directives:

Safety: 2006/95/EC Low Voltage Directive

EMC: 2004/108/EC Electromagnetic Compatibility Directive



Waste electrical products should not be disposed of with household waste. Please recycle where facilities exist. Check with your Local Authority or retailer for recycling advice.

